

VERA GSK36

Assembly Instructions

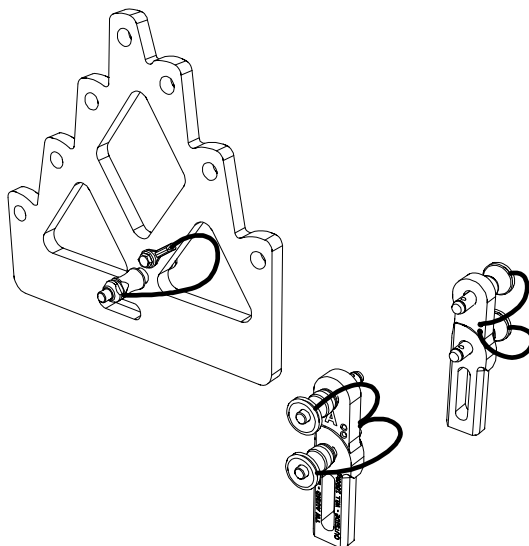

Introduction

Thank you for choosing a high-quality product “MADE IN GERMANY” from the brand TWAUDIÖ.

The VERA GSK36 groundstack-kit is an accessory for the VERA36 loudspeaker and the VERARF900 rigging frame.

It is characterized by a subtle look, a remarkable size to weight ratio and ease of use.

If you lend your product to another party, inform that party of the safety-related operating procedures and hand over this assembly guide. If you require additional copies of this manual, you can obtain them free of charge from TWAUDIÖ or download them from www.twaudio.de

Instructions in this setup manual

Strictly adhere to the instructions contained in this operating manual that are marked as follows:



This symbol in combination with the signal word “Warning” identifies a potentially hazardous situation. Failure to comply with this safety instruction can lead to serious injury or even death.



This symbol in combination with the signal word “Warning” identifies a potentially hazardous situation. Failure to comply with this safety instruction can lead to serious injury or even death.



This symbol in combination with the signal word “Caution” identifies a potentially hazardous situation. Failure to comply with this safety instruction can lead to light or moderate injury.



This symbol in combination with the signal word “Note” identifies a potentially hazardous situation. Failure to comply with this safety instruction can lead to product damage.



This symbol in combination with the signal word “Tip” identifies additional information or notes that will simplify working with TWAUDIÖ products on the basis of practical experience.

Notes on the products

Read manual before use!

Before using the groundstack-kit, carefully read the assembly instructions and keep the instructions in a safe place together with the VERAGSK36 groundstack-kit.

General Information

Assembly Guide: OM-VERAGSK36

Version 2.0 d, 02/2023

© by TWAMBO 2023; all rights reserved.

All information contained in this operating manual was correct to the best of our knowledge at the time of printing.

Quality warranties or assurance of suitability for a certain type of use based on the technical specifications, dimensions and weights are not granted by TWAMBO.

TWAMBO also shall not assume liability for any secondary damage (property damage and/or personal injury) nor for the failure to comply with this operating manual!

TWAMBO reserves the right to update this document based on recent developments.

TWAMBO GmbH
Karl-Hofer-Str. 42
14163 Berlin
Germany

Phone : + 49 (0) 71 41-48 89 89 0
Fax: + 49 (0) 71 41-48 89 89 99
E-Mail: info@twaudio.de
WWW: www.twaudio.de

Content

| | |
|--|----|
| 1. Safety Intended use | 5 |
| 2. Overview | 6 |
| 2.1 Scope of delivery | 6 |
| 2.2 Placement the VERAGSK36 for storage at the VERARF900 | 7 |
| 3. Technical Data | 8 |
| 3.1 Data sheet | 8 |
| 4. Commissioning | 9 |
| 4.1 Setup | 9 |
| 4.2 Wind load | 9 |
| 4.3 Pitfalls | 9 |
| 4.4 Danger of tipping over | 10 |
| 4.5 System setup VERARF900 with VERAGSK36 on the ground | 11 |
| 4.6 System setup VERARF900 with VERAGSK36 on VERAS33 loudspeaker | 11 |
| 4.7 Groundstack VERA36 loudspeaker on VERAGSK36 | 12 |
| 5. Transport and Storage | 20 |
| 6. CE Declaration of Conformity | 21 |
| 7. Disposal | 21 |

1. Safety | Intended use

Please adhere to the following safety instructions to avoid risks when using accessories.

The VERAGSK36 groundstack-kit was developed for use in professional sound systems. The groundstack-kit may only be used by trained and qualified personnel.

Note the operating modes described in this assembly instructions. Other uses are not permissible.

Damage caused by improper use is not covered by TWAMBO.



Before every operation, check the scope of delivery of the VERAGSK36 groundstack-kit for its completeness and ensure that all parts are in perfect condition.

The scope of delivery includes specified components. Only use the recommended and certified components.



The VERAGSK36 groundstack-kit may only be used with the VERA36 loudspeaker and the VERARF900 rigging frame.

This rigging manual describes how to use the VERAGSK36 groundstack-kit correctly. Any other use shall be deemed improper and may result in damage or even injury.

Modifications or alterations to individual parts of the VERAGSK36 groundstack-kit are not permitted! Danger to life!



During and after each system setup, check that all quick-locking pins are always completely inserted! All quick-locking pins must always be used!



The VERAGSK36 groundstack-kit is an accessory designed both for indoor and outdoor use.



The VERAGSK36 groundstack-kit set may only be used by trained and qualified personnel. Personnel must check the VERAGSK36 for its full suitability before each use.



When visible damage to any part of the VERAGSK36 groundstack-kit set is detected, it must be decommissioned immediately.

2. Overview

2.1 Scope of delivery



The VERAGSK36 consists of a rear-adapter with quick-locking pins as well as a boxlink connector A and a boxlink connector B with two quick-locking pins each.

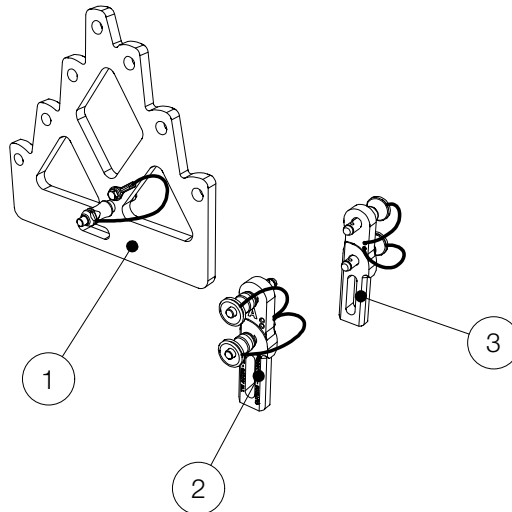

Figure 2.1 - Groundstack-kit VERAGSK36

1. Rear-adapter
2. Boxlink connector A
3. Boxlink connector B

2.2 Placement the VERAGSK36 for storage at the VERARF900

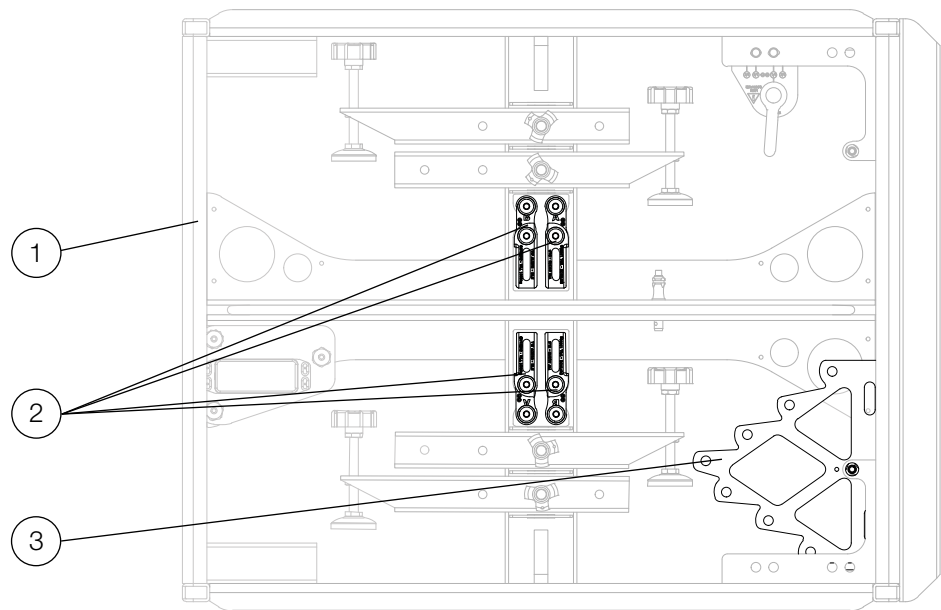

Figure 2.2 - Overview VERARF900 with VERAGSK36

1. Rigging frame VERARF900
2. Possible positions: boxlink connector A and B VERAGSK36
3. Possible position: rear-adapter VERAGSK36



WARNING

For storage, first insert all quick-locking pins through the mounting holes of the VERAGSK36 groundstack-kit and then through the mounting holes on the VERARF900 rigging frame.

Make sure that the groundstack-kit is securely attached to the VERARF900 rigging frame.

3. Technical Data

3.1 Data sheet

| | |
|-----------------------|-----------------|
| maximum load capacity | 12x VERA36 |
| Weight | 1.0kg [2,20lbs] |
| Surface | Powder coated |

4. Commissioning

4.1 Setup

The VERAGSK36 groundstack-kit is designed for groundstack operation.



Please note that setting up the system setups always requires two persons!



Make sure that all system structures are located on a firm, level surface and that the surface can bear the total weight!



TWAUDIÖ recommends using only the accessories specified by TWAUDIÖ for securing and mounting the groundstack-kit.

4.2 Wind load



Before setting up the system outdoors, consider unforeseeable wind conditions at the operation site!

In the event of imminent danger, dismantle your system structures immediately!

4.3 Pitfalls



Make sure that no one can trip over your system structures, or over individual components! This is especially true for all pressure-resistant shims, tripod legs and bracing ropes!

4.4 Danger of tipping over



The center of gravity of the configuration can be used as a guide to the stability of the groundstack system design. This can be determined by simulating the system structure in the EASE Focus simulation software. It should always be plumb above the VERARF900 rigging frame.

Secure every system setup against falling over!

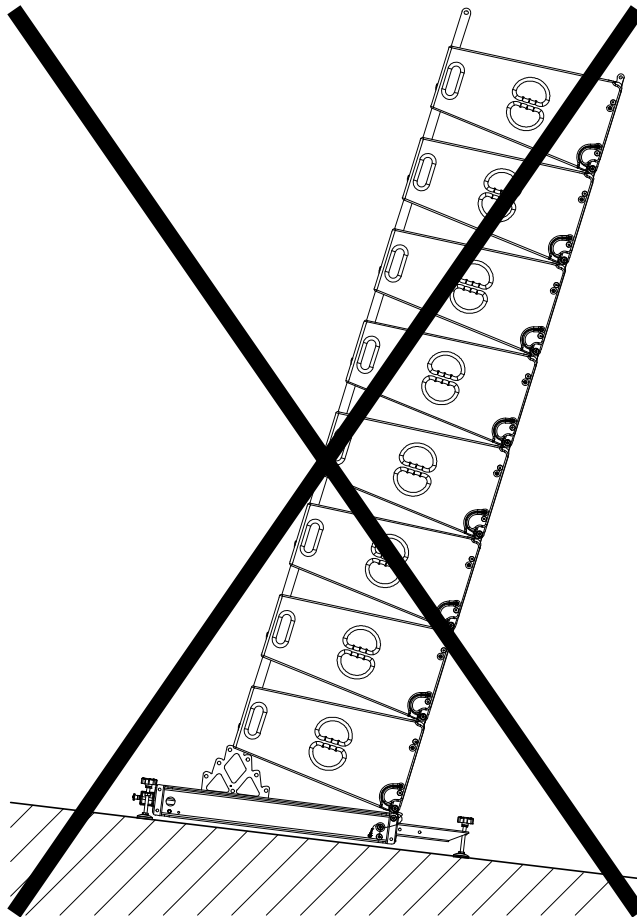

Figure 4.4 - System structure - Danger of tipping



Make sure that no unauthorized persons can access the system structures!

Cordon off the area professionally!



Any influences on your system setup, such as leaning against objects (or people) and flying objects around, be refrained from!

4.5 System setup VERA RF900 with VERA GSK36 on the ground



Please note the VERA ORF900 outrigger assembly instructions prior to any system setup on the floor.



1. Always level the VERA RF900 rigging frame using a spirit level before commencing system construction. To do so, turn the spindle feet.
2. When setting up a system on uneven surfaces, such as gravel or grass, always put a pressure-resistant surface under all four spindle feet!
3. Make sure that all four spindle feet rest completely on the pressure-resistant shims and that the surface can withstand the total weight.

4.6 System setup VERA RF900 with VERA GSK36 on VERA S33 loudspeaker



Prior to any system setup of the VERA RF900 rigging frame with the VERA GSK36 ground-stack-kit, note that the VERA RF900 rigging frame is attached to the VERA S33 loudspeaker with the BLS boxlink connector set. Use all quick-locking pins of the boxlink connector set BLS!

Check that all quick-locking pins are completely inserted!

4.7 Groundstack VERA36 loudspeaker on VERA GSK36

To set up the groundstack array with VERA36 loudspeakers on the VERA GSK36 groundstack-kit, proceed as follows:



1. Loosen all quick-locking pins on both boxlink connectors A and B of the VERA GSK36 groundstack-kit.

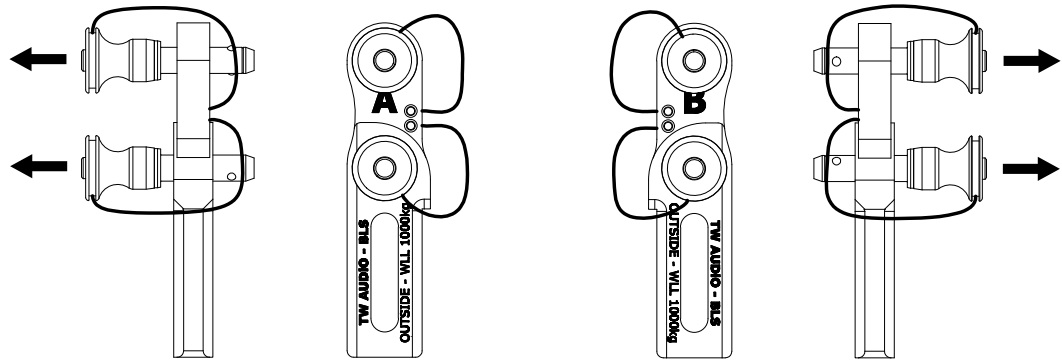

Figure 4.7.1 - Boxlink connector BLS



2. Plug the boxlink connector A into the VERARF900 rigging frame at the front left. Pay attention to the alignment of the boxlink connector. Labeling A must be readable from outside.
3. Then insert the first quick-locking pin into the top hole on the VERARF900 rigging frame to secure the boxlink connector A. After that insert the second quick-locking pin into the storage position on the VERARF900 rigging frame.
4. Check that all quick-locking pins are completely inserted!

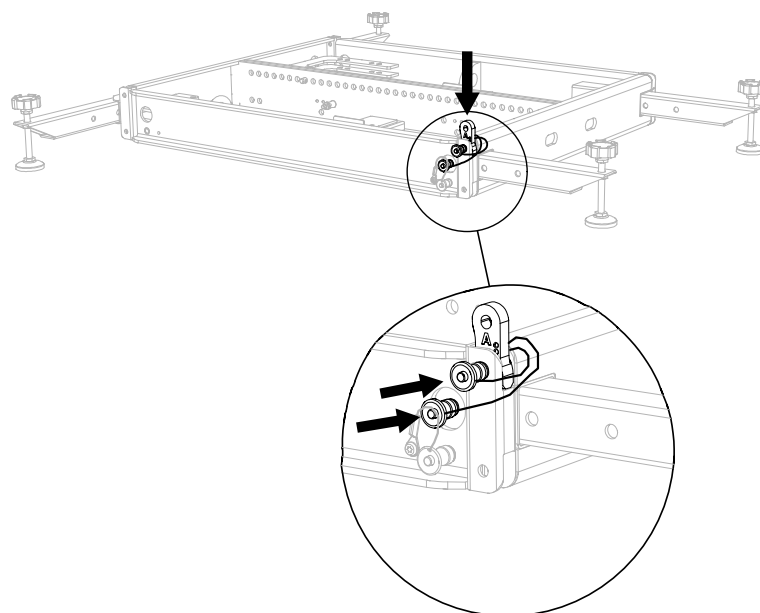

Figure 4.7.2 - Plug BLS A and both quick-locking pins at VERARF900



5. Plug the boxlink connector B into the VERARF900 rigging frame at the front right. Pay attention to the alignment of the boxlink connector. Labeling B must be readable from outside.
6. Then insert the first quick-locking pin into the top hole on the VERARF900 rigging frame to secure the boxlink connector B. After that insert the second quick-locking pin into the storage position on the VERARF900 rigging frame.
7. Check that all quick-locking pins are completely inserted!

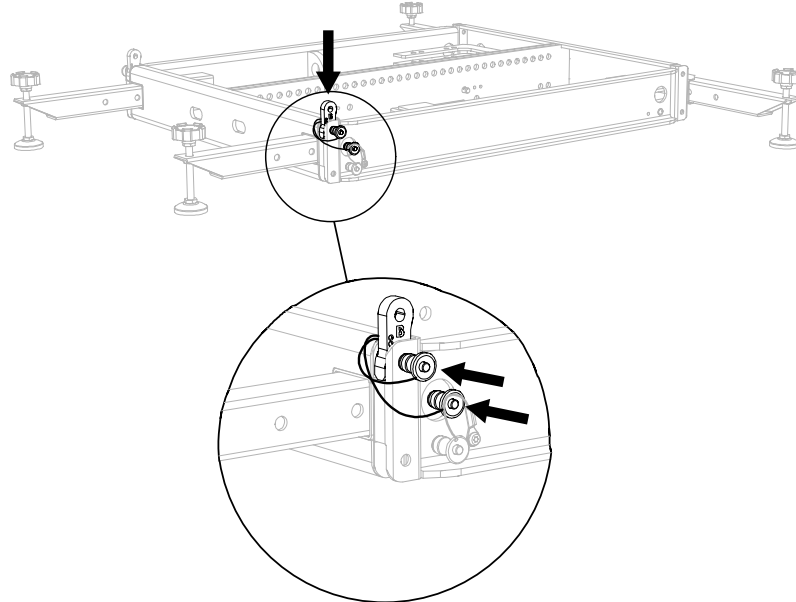

Figure 4.7.3 - Plug BLS B and both quick-locking pins at VERA RF900



8. Loosen the two front quick-locking pins on the VERA36 loudspeaker.

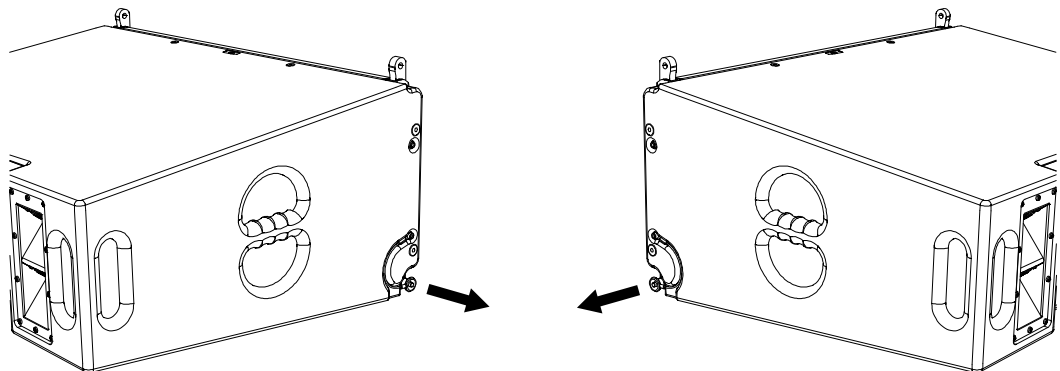

Figure 4.7.4 - Loosen quick-locking pins



9. Using two people, lift the prepared VERA36 loudspeaker onto the prepared VERA RF900 rigging frame.
10. Make sure that the boxlink connectors engage in the rigging tracks of the loudspeaker!

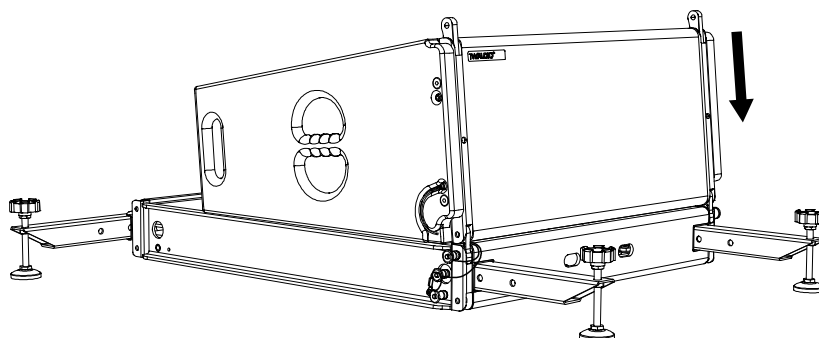

Figure 4.7.5 - Set VERA36 loudspeaker on VERA RF900 rigging frame



11. Now fasten the two front quick-locking pins of the VERA36 loudspeaker in the holes of the two boxlink connectors.
12. Check that all quick-locking pins are completely inserted!

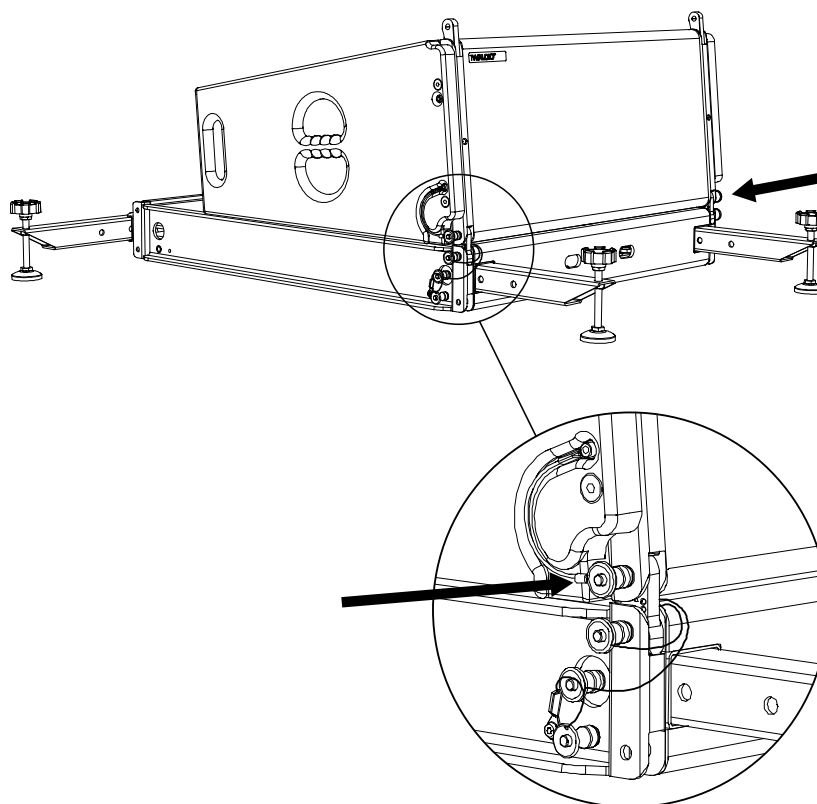

Figure 4.7.6 - Set quick-locking pins



13. Loosen the quick-locking pin on the VERA36 loudspeaker's rear rigging.

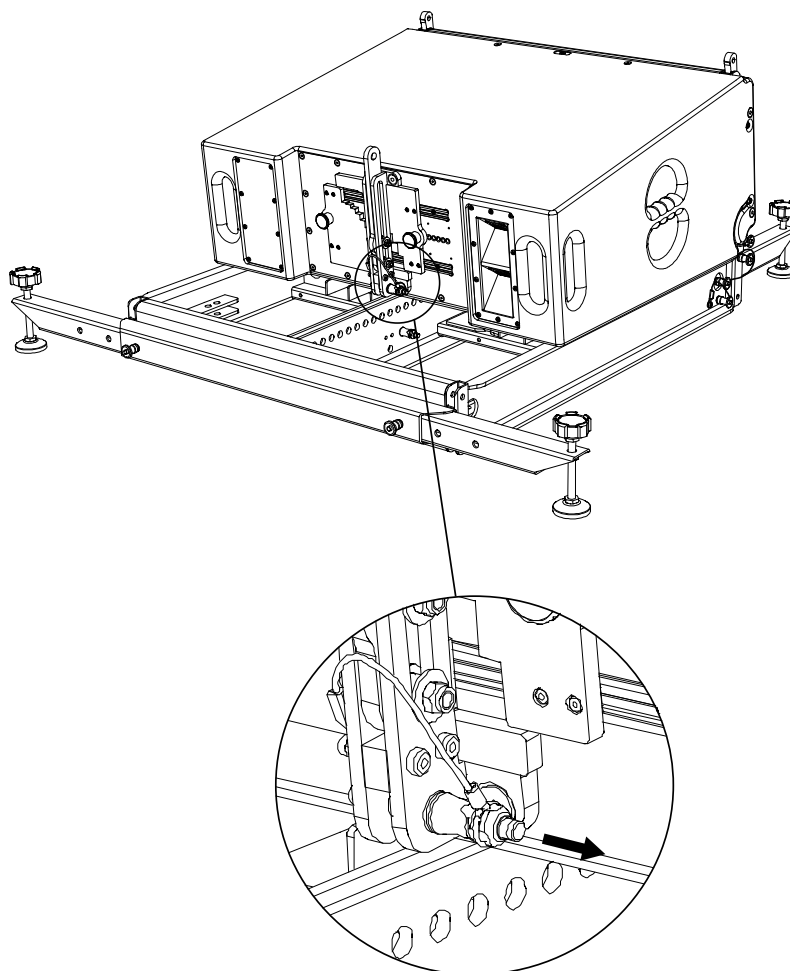

Figure 4.7.7 - Loosen quick-locking pin at rear rigging



14. Use the EASE Focus simulation software to determine the degrees of the VERA GSK36 rear-adapter as well as the number and degrees of the VERA36 loudspeakers that match your application.

15. Select the level (number of degrees) that matches your system application. See Figures 4.7.8 to 4.7.14.

Variants:

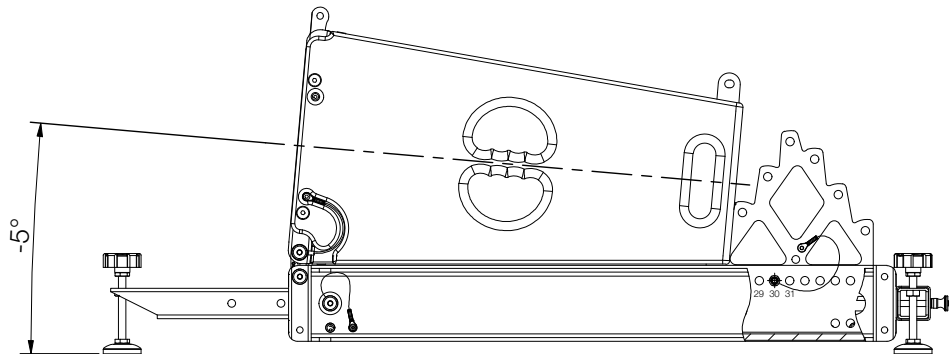

Figure 4.7.8 - Side view VERA36 loudspeaker -5° uptilt

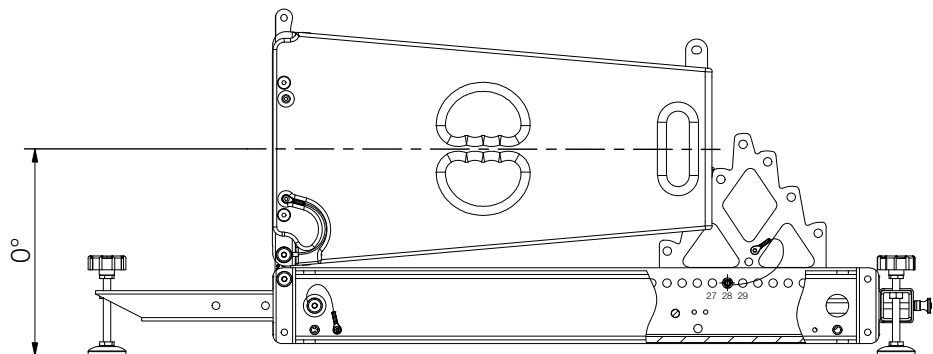

Figure 4.7.9 - Side view VERA36 loudspeaker 0° (horizontal)

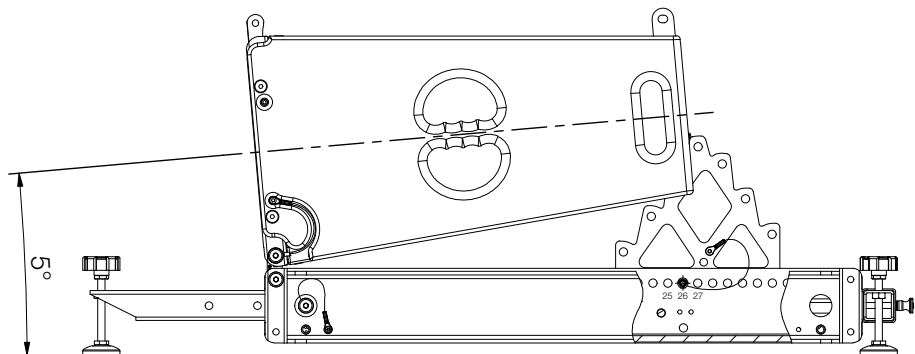

Figure 4.7.10 - Side view VERA36 loudspeaker 5° downtilt

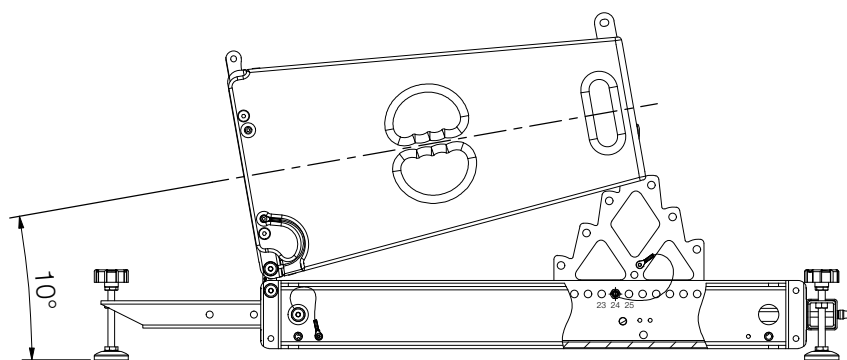

Figure 4.7.11 - Side view VERA36 loudspeaker 10° downtilt

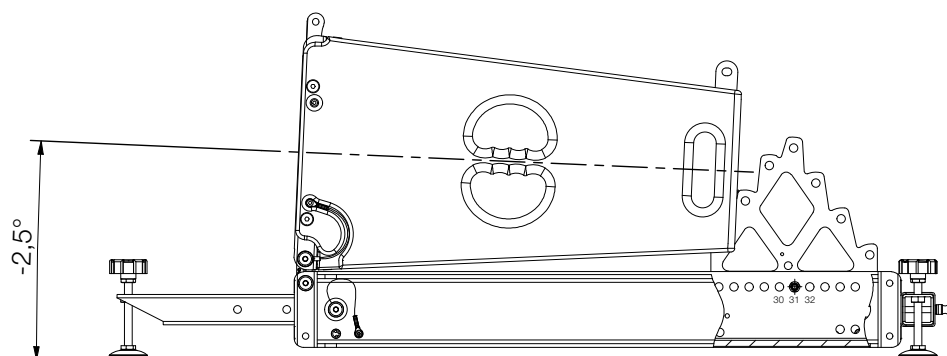

Figure 4.7.12 - Side view VERA36 loudspeaker -2,5° uptilt

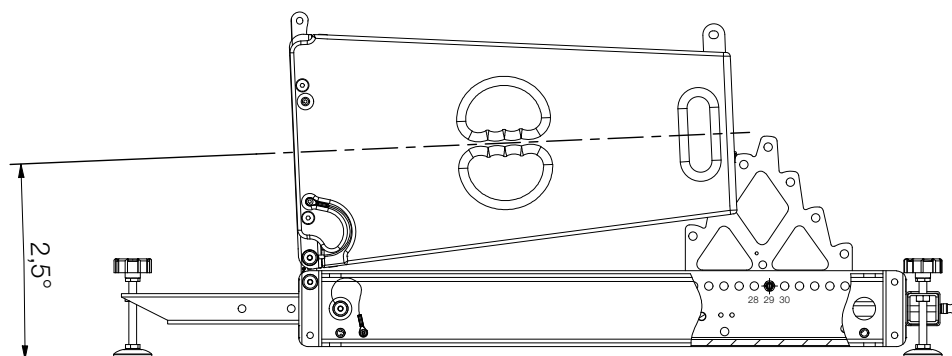

Figure 4.7.13 - Side view VERA36 loudspeaker 2,5° downtilt

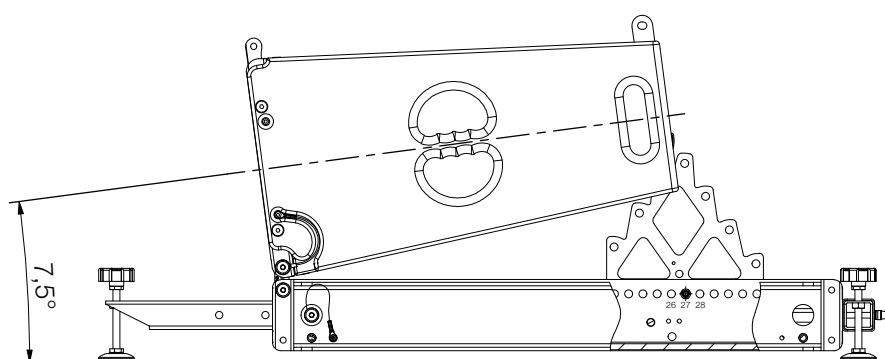

Figure 4.7.14 - Side view VERA36 loudspeaker 7,5° downtilt



16. Lift the VERA36 loudspeaker with one hand and with the other hand insert the VERA GSK36 rear-adapter (see figure 2.1 - Pos.1), with the previously selected number of degrees, into the center brace of the VERARF900 rigging frame. Slide this under the hook on the rear rigging of the VERA36 loudspeaker.

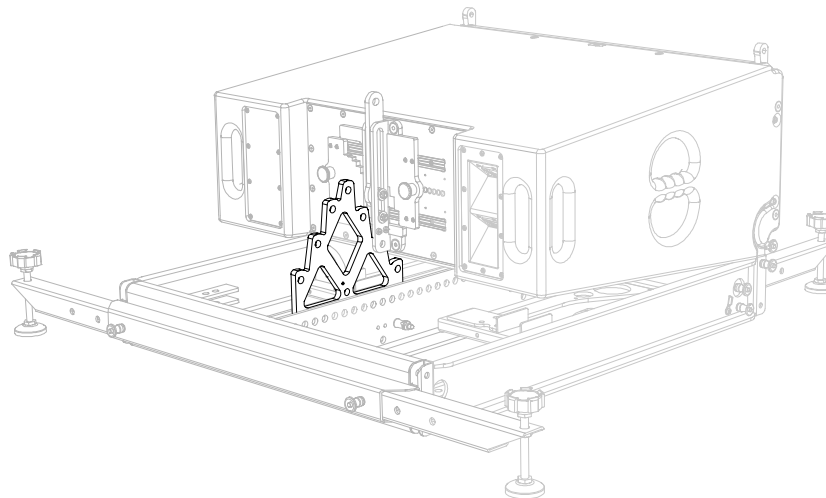

Figure 4.7.15 - Set VERA GSK36 rear-adapter into the center brace of the VERARF900 rigging frame



17. Then attach the VERA GSK36 rear-adapter to the rear rigging using the quick-locking pin provided on the VERA36 loudspeaker.
18. Check that the quick-locking pin is completely inserted!

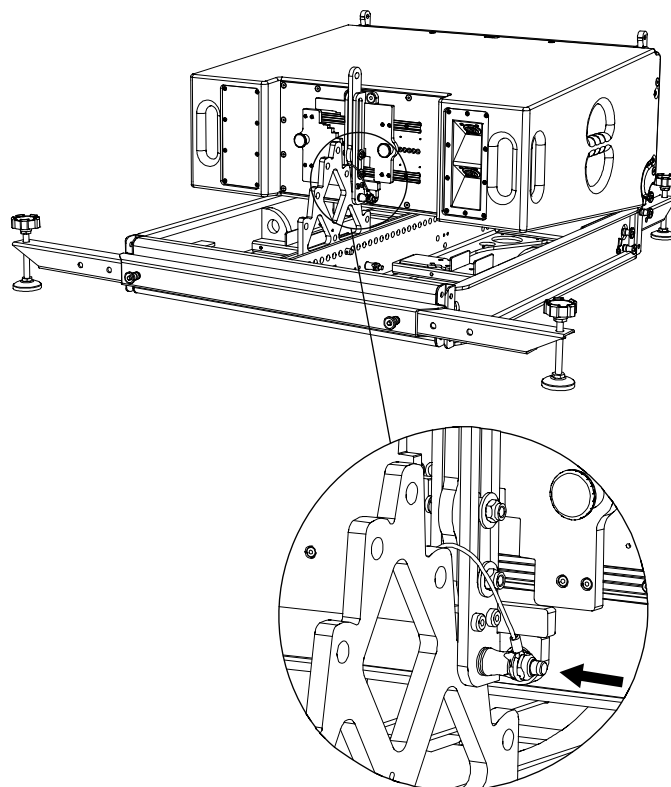

Figure 4.7.16 - Set quick-locking pin at rear rigging



19. After that attach the VERAGSK36 rear-adaptor to the center brace of the VERARF900 rigging frame using the quick-locking pin provided on the rear-adaptor.
20. Check that the quick-locking pin is completely inserted!

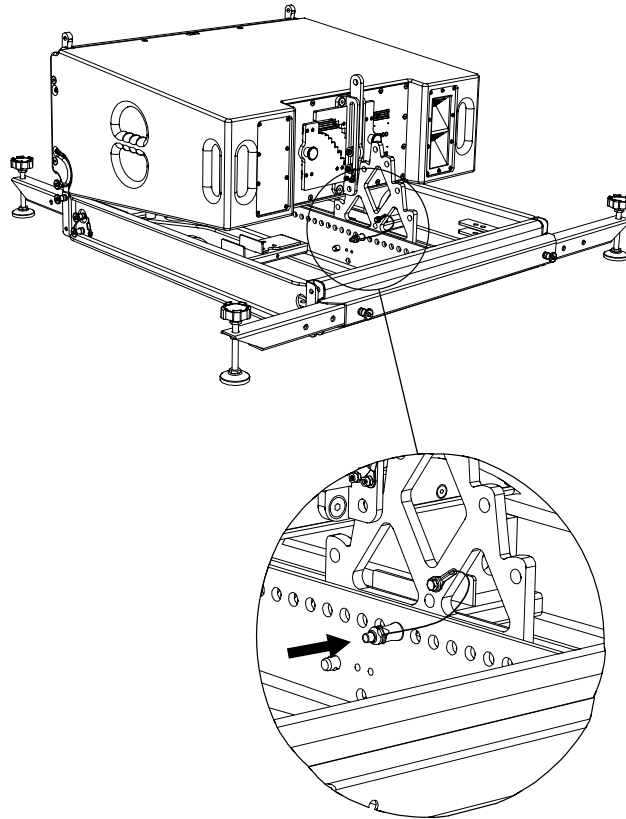

Figure 4.7.17 - Set quick-locking pin on the center brace of the VERARF900 rigging frame.



21. Proceed according to the operating instructions of the VERARF900 rigging frame when further setting up up to max. 12 VERA36 loudspeakers.

5. Transport and Storage



Ensure that the surfaces of the groundstack-kit are not damaged during transport and storage. Moisture may penetrate where steel surfaces are exposed by scratches and result in corrosion.

This is why the product should be transported and stored in a safe, careful, dry and largely dust-free manner.

The original packaging is not suitable as permanent storage and transport packaging.

6. CE Declaration of Conformity

Copy and translation of the original CE Conformity Declaration:



We hereby declare that the below-referenced components by virtue of their design and construction, and in the configuration placed on the market by us, satisfy the safety and health requirements of the applicable EC directives. This declaration becomes invalid in case of modifications that have not been approved by us.

This declaration applies to the following components

- VERAGSK36

as well as all model variants based on these, provided that they correspond to the original factory models and have not been technically modified in any way.

Applicable directives:

- 2001/95/EG

Applicable national standards and technical specifications:

- DIN EN 18800
- DIN EN ISO 12100
- DGUV Vorschrift 17 und 18

Berlin, Germany, January 1st, 2021

Bernhard Wüstner

7. Disposal

If you have any question regarding the disposal of used devices, please contact us under the following telephone number:

+49 (0) 71 41 - 48 89 89 0

In countries outside of the European Union, comply with local regulations.

TWAMBO GmbH
Karl-Hofer-Str. 42
14163 Berlin
Germany

Phone: + 49 (0) 71 41-48 89 89 0
Fax: + 49 (0) 71 41-48 89 89 99
E-Mail: info@twaudio.de
WWW: www.twaudio.de