

# VERA LA900

## Assembly Instructions

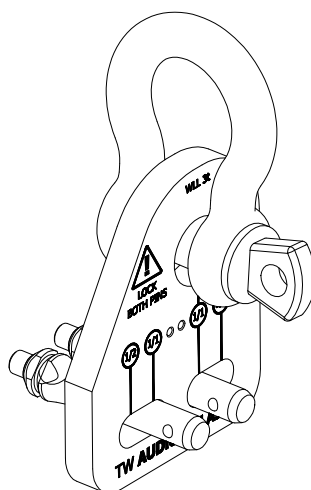

## Introduction

Thank you for choosing a high-quality product “MADE IN GERMANY” from the brand TWAUDIÖ.

The VERA LA900 load adapter (with shackle) is an accessory part for the rigging frames of the VERA20 and VERA36 series.

It is characterized by a subtle look, a remarkable size to weight ratio and ease of use.

If you lend your product to another party, inform that party of the safety-related operating procedures and hand over this assembly guide. If you require additional copies of this manual, you can obtain them free of charge from TWAUDIÖ or download them from [www.twaudio.de](http://www.twaudio.de)

### Instructions in this setup manual

Strictly adhere to the instructions contained in this operating manual that are marked as follows:



This symbol in combination with the signal word “Warning” identifies a potentially hazardous situation. Failure to comply with this safety instruction can lead to serious injury or even death.



This symbol in combination with the signal word “Caution” identifies a potentially hazardous situation. Failure to comply with this safety instruction can lead to light or moderate injury.



This symbol in combination with the signal word “Note” identifies a potentially hazardous situation. Failure to comply with this safety instruction can lead to product damage.



This symbol in combination with the signal word “Tip” identifies additional information or notes that will simplify working with TWAUDIÖ products on the basis of practical experience.

## Notes on the products

**Read manual  
before use!**

Before using the load adapter, carefully read the assembly instructions and keep the instructions in a safe place together with the VERA LA900 load adapter.

## General Information

Assembly Guide: OM-VERA LA900  
Version 2.0 d, 11/2022  
© by TWAMBO 2022; all rights reserved.

All information contained in this operating manual was correct to the best of our knowledge at the time of printing.

Quality warranties or assurance of suitability for a certain type of use based on the technical specifications, dimensions and weights are not granted by TWAMBO.

TWAMBO also shall not assume liability for any secondary damage (property damage and/or personal injury) nor for the failure to comply with this operating manual!

TWAMBO reserves the right to update this document based on recent developments.

TWAMBO GmbH  
Karl-Hofer-Str. 42  
14163 Berlin  
Germany

Phone : + 49 (0) 71 41-48 89 89 0  
Fax: + 49 (0) 71 41-48 89 89 99  
E-Mail: [info@twaudio.de](mailto:info@twaudio.de)  
WWW: [www.twaudio.de](http://www.twaudio.de)

## Table of contents

1. Safety   Intended use .....	5
2. Overview .....	7
2.1 Components .....	7
3. Technical specifications .....	8
3.1 Data sheet .....	8
4. Commissioning .....	9
4.1 Use of VERA LA900 load adapter .....	9
4.2 Compression mode .....	11
5. Transport and Storage .....	12
6. CE Declaration of Conformity .....	13
7. Disposal .....	13

## 1. Safety | Intended use

Please adhere to the following safety instructions to avoid risks when using accessories.

The VERA LA900 load adapter was developed for use in professional sound systems. The load adapter may only be used by trained and qualified personnel.

Note the operating modes described in this assembly instructions. Other uses are not permissible.

Damage caused by improper use is not covered by TWAMBO.



Before each installation, check the integrity of the VERA LA900 load adapter and ensure that all components are in perfect condition.

The scope of delivery includes specified quick-locking pins. Only use this quick-locking pins.



The VERA LA900 load adapter must only be used with products of the VERA20 and VERA36 series.

These assembly instructions describe how to use the VERA LA900 load adapter. Any other use shall be deemed improper and may result in damage or even injury.

Modifications or alterations to individual parts of the VERA LA900 load adapter are not permitted! Danger to life!



At each system setup, check that all quick-locking pins are always completely inserted! All quick-locking pins must always be used!



The VERA LA900 is an accessory designed both for indoor and outdoor use.



The VERA LA900 load adapter may only be used by trained and qualified personnel. Personnel must check the VERA LA900 for its full suitability before each use.



When visible damage to any part of the VERA LA900 load adapter is detected, it must be decommissioned immediately.



Before mounting the VERA LA900 load adapter check that walls, ceilings, tripods etc are capable of carrying the payload of the components.

The VERA LA900 load adapter is designed for a payload of 1.5 to [3307 lbs].  
Do not exceed this payload!



Check the screw connection at every installation of the VERA LA900 load adapter. Tighten if loose. If this is not possible, replace the fasteners.

## 2. Overview

### 2.1 Components

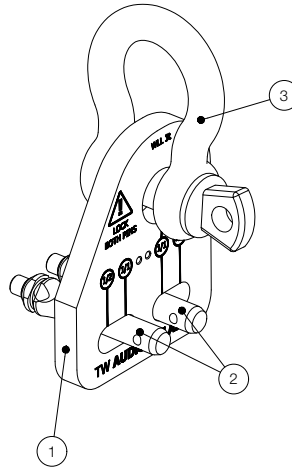

**Figure 2.1 - Overview**

1. Rigging plate - surface KTL-coated as well as colorless-powder-coated
2. Captive quick-locking pins
3. Shackle 3.25 tonnes

### 3. Technical specifications

#### 3.1 Data sheet

maximum load capacity	1,5 to [3307 lbs] (3 to WLL) [6614 lbs]
Dimensions (h x w x d)	150 x 100 x 70 mm [5,91 x 3,94 x 2,76 in]
Weight	1.1 kg [2,4 lbs]
Surface	KTL-coated as well as colorless-powder-coated



## 4. Commissioning

### 4.1 Use of VERA LA900 load adapter

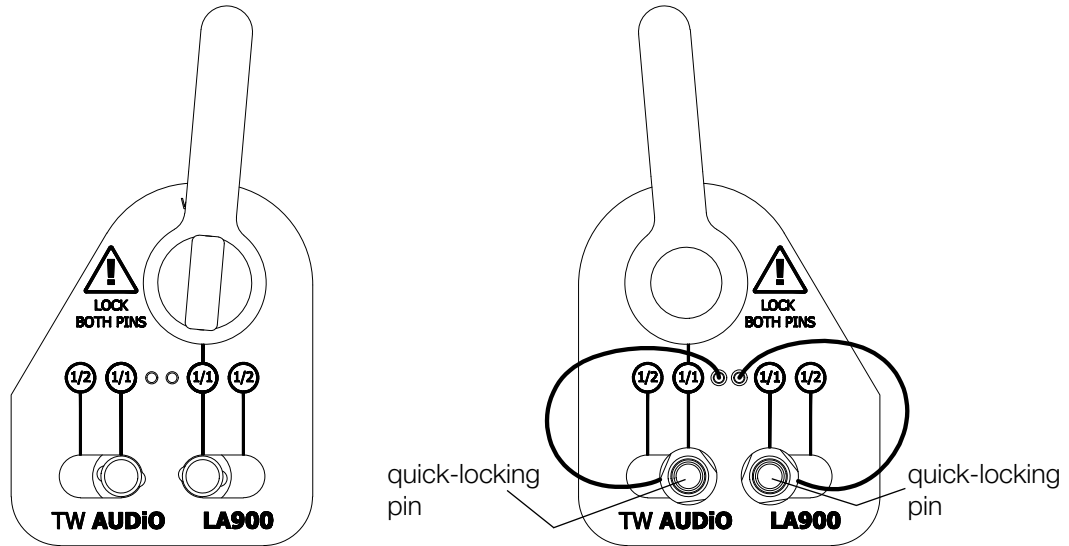

Figure 4.1.1 - VERA LA900 load adapter



Two quick-locking pins are attached to the VERA LA900 load adapter.

Fasten the VERA LA900 load adapter to the rigging frame of the VERA20 und VERA36 series with both quick-locking pins!



Use the EASE Focus simulation software to determine the appropriate pin points for your application.

The VERA LA900 load adapter is designed for use in four different ways.

The two integrated oblong holes enable settings in full steps as well as half steps. The marking on the shackle of the VERA LA900 load adapter indicates the current setting. This can be clearly seen in figures 4.1.2 to 4.1.5.

The following figures show various configurations in an example:

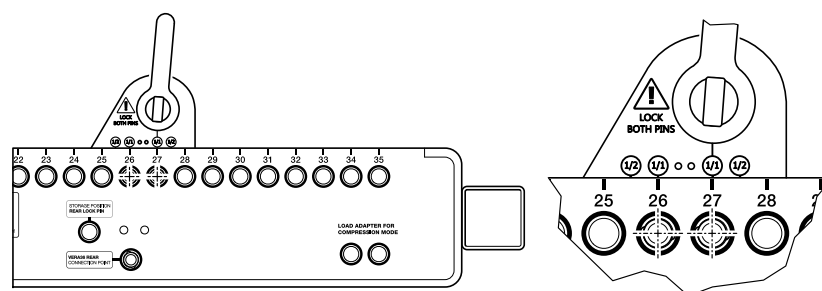

**Figure 4.1.2 - VERA LA900 load adapter set to position 27 - facing forward**

With the VERA LA900 load adapter facing forward, the quick-locking pins plugged into 26 and 27 result in a pin point of 27.

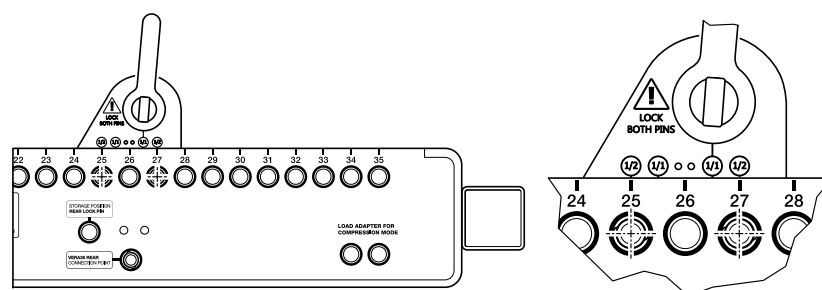

**Figure 4.1.3 - VERA LA900 load adapter set to position 26,5 - facing forward**

If the quick-locking pin of the VERA LA900 load adapter is moved from 26 to 25, this results in a pin point of 26,5.

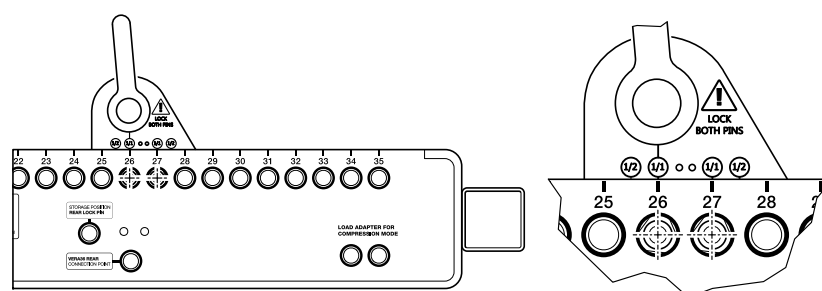

**Figure 4.1.4 - VERA LA900 Lastadapter set to position 26 - facing rearward**

With the VERA LA900 Lastadapter facing rearward, the quick-locking pins plugged into 26 and 27 result in a pin point of 26.

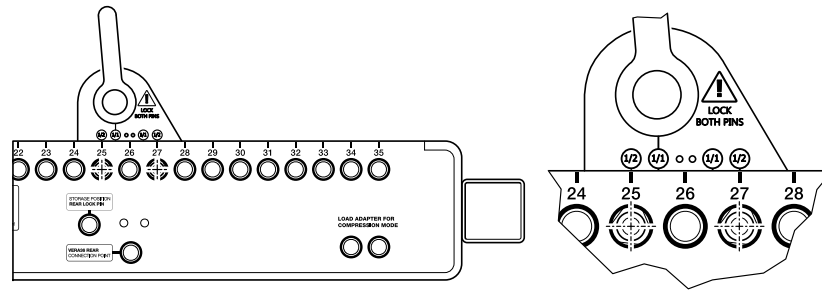

**Figure 4.1.5 - VERA LA900 load adapter set to position 25,5 - facing rearward**

If the quick-locking pin of the VERA LA900 load adapter is moved from 26 to 25, this results in a pin point of 25,5.

## 4.2 Compression mode



Use of the compression mode is recommended for large systems with more than 9 elements. In this operation mode, all line-array elements are connected at 0°; the required angle settings are only preselected when lifting. When all line-array elements are interconnected, an additional chain hoist can be used to pull the complete system to the right angle.

The chain hoist for this is attached between the VERA RF900 rigging frame and an additional SFV36 rigging frame at the end of the array.

A VERA LA900 load adapter must be used for attaching to the VERA RF900 rigging frame.

At the marking „Load adapter for compression mode“, fasten the VERA LA900 load adapter to the flying frame of the VERA20 or VERA36 series from below.

Use both quick-locking pins.

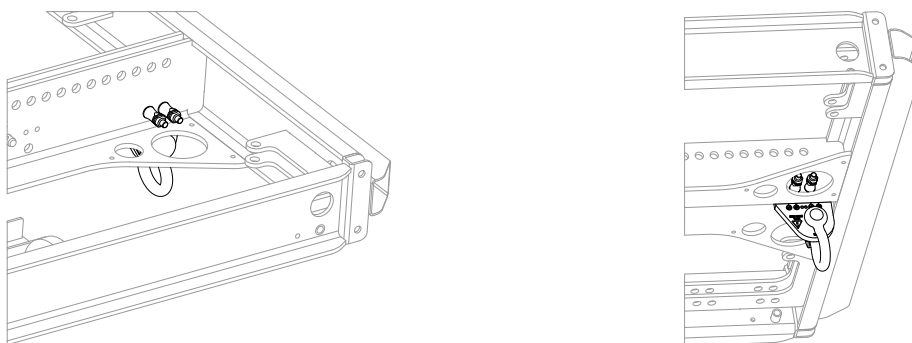

**Figure 4.2.1 - VERA LA900 load adapter at the position „Load adapter for compression mode“**



The VERA LA900 load adapter can also be used at this position for attaching a cable strain relief for loudspeaker cables.

## 5. Transport and Storage



### NOTE

Ensure that the surface of the load adapter is not damaged during transport and storage. Moisture may penetrate where steel surfaces are exposed by scratches and result in corrosion.

This is why the product should be transported and stored in a safe, careful, dry and largely dust-free manner.

The original packaging is not suitable as permanent storage and transport packaging.

## 6. CE Declaration of Conformity

Copy and translation of the original CE Conformity Declaration:



We hereby declare that the below-referenced components by virtue of their design and construction, and in the configuration placed on the market by us, satisfy the safety and health requirements of the applicable EC directives. This declaration becomes invalid in case of modifications that have not been approved by us.

### **This declaration applies to the following components**

- VERA LA900

as well as all model variants based on these, provided that they correspond to the original factory models and have not been technically modified in any way.

### **Applicable directives:**

- 2001/95/EG

### **Applicable national standards and technical specifications:**

- DIN EN 18800
- DIN EN ISO 12100
- DGUV Vorschrift 17 und 18

Berlin, Germany, January 1st, 2021

  
Bernhard Wüstner

## 7. Disposal

If you have any question regarding the disposal of used devices, please contact us under the following telephone number:

+49 (0) 71 41 - 48 89 89 0

In countries outside of the European Union, comply with local regulations.

TWAMBO GmbH  
Karl-Hofer-Str. 42  
14163 Berlin  
Germany

Phone: + 49 (0) 71 41-48 89 89 0  
Fax: + 49 (0) 71 41-48 89 89 99  
E-Mail: [info@twaudio.de](mailto:info@twaudio.de)  
WWW: [www.twaudio.de](http://www.twaudio.de)