



The C5 is our most compact, high performance, universally applicable passive loudspeaker. With a 5" coax driver delivering 110 degree dispersion, the C5 is ideal for near field applications such as an on-stage frontfill, or as an unobtrusive monitor in a TV studio environment.

As loud as it is little, the C5 combines a compact footprint with the natural reproduction and extraordinary SPL of far larger systems. It also benefits from a carefully constructed and precisely balanced passive crossover making it suitable for direct use on standard amplifiers without additional adjustments.

Finally, its rugged construction, including an integral rigid foam enclosure and shock resistant PU varnish as standard, also makes the C5 suitable for permanent outdoor installations.*

*IP54 rating achieved with WPC5 mounted

Key Features

- » Compact, lightweight (3.9kg | 8.6lbs) universally applicable passive loudspeaker
- » 110 degree wide radiating 5" coaxial driver
- » Passive crossover allows direct use on standard amplifiers without additional adjustments
- » Several installation accessories available
- » IP54 rating achieved with WPC5 installation cover (with cable gland) mounted
- » The high performance variant to the C5i
- » Coherent phase response with all TWAUDIÖ subwoofers
- » Operation with dedicated TWAUDIÖ presets on Lab.gruppen, Powersoft or Dynacord TGX and IPX amplifiers

Applications

- » Galas, events and shows
- » Churches, houses of worship, religious places
- » Theatres and cultural places
- » Bars and restaurants
- » Arenas and sports venues
- » Concerts and touring

Technical Data

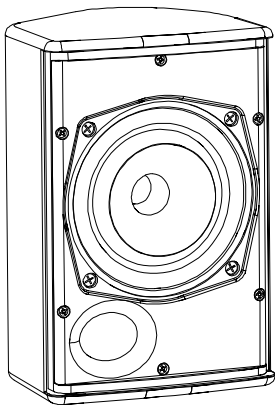

Drivers	1x 5" LF 1x 1" HF with 1,75" diaphragm
Frequency range	90 - 20000Hz
Power capacity program/peak	250/500W
Impedance	24 Ω
Coverage (h x v)	110° radial
Sensitivity 1W/1m	91 dB
SPLmax / 1m	117 dB
Connection	2x speakON® NL4 1± Clamped connection: red (+) / black (-)
Dimensions (H x W x D)	240 x 160 x 160 mm 9.45 x 6.30 x 6.30 in
Weight	3.9 kg 8.6 lbs
Finish	Warnex textured paint (RAL colors optional)
Accessories	see twaudio.com

Technical Drawing

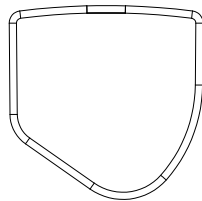

bottom view

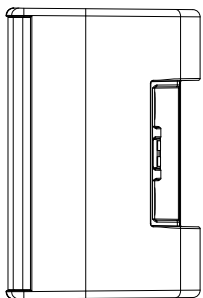

right view

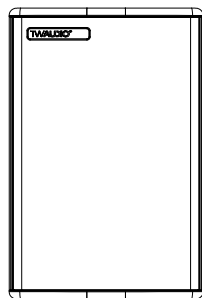

front view

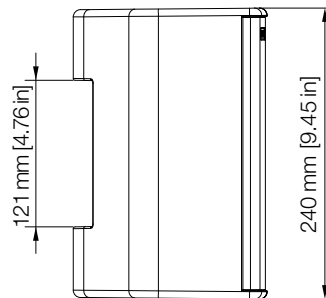

left view

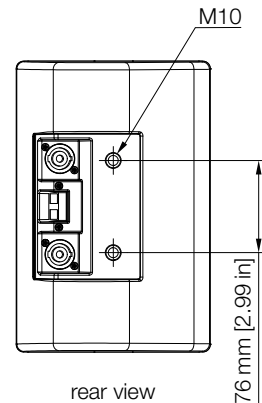

rear view

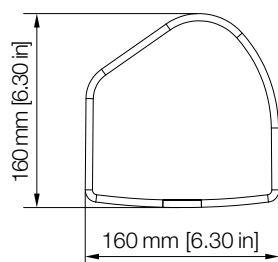

top view

Frequency Response

FULL mode / **FLAT mode** / CUT mode | IMPEDANCE

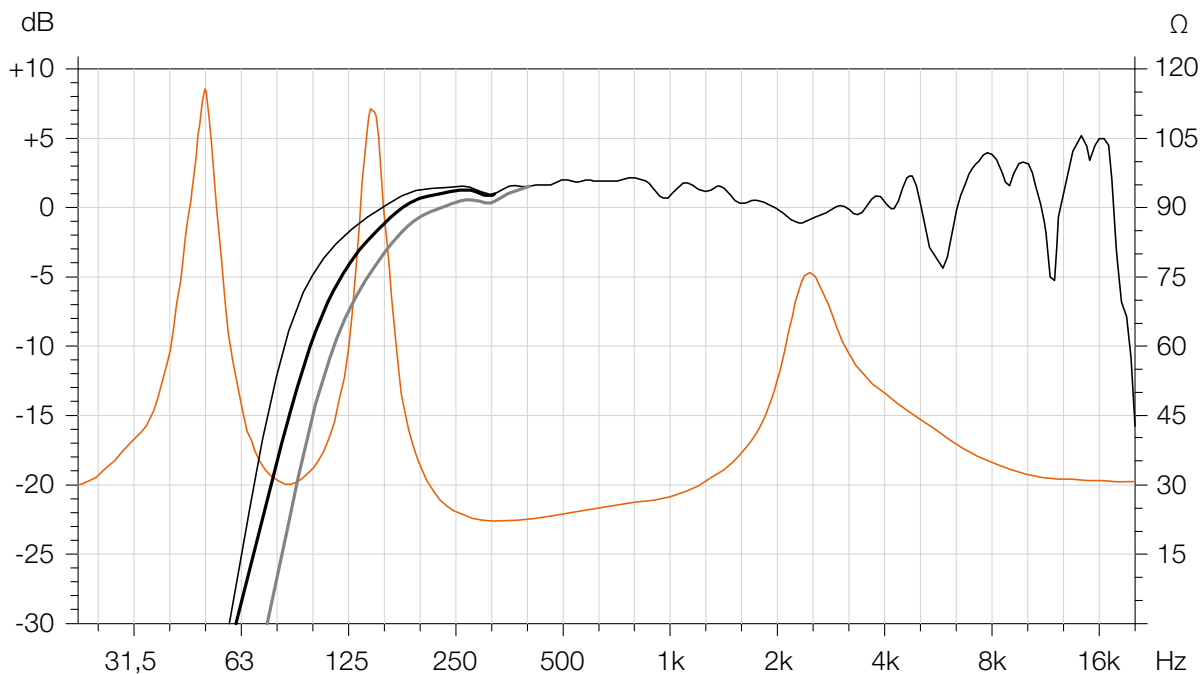

Radiation Pattern

-6 dB | -12 dB

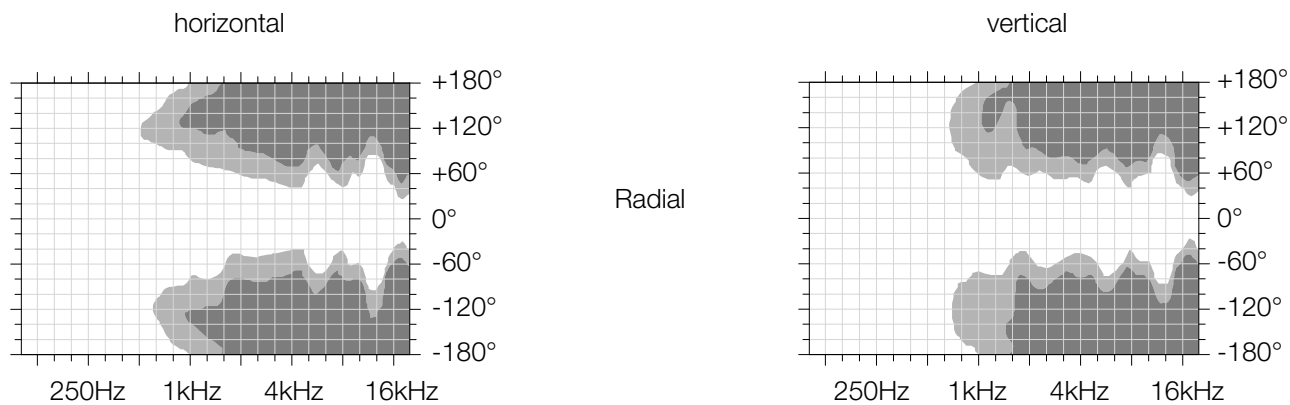

Architect Specifications

The loudspeaker shall consist of a compact and lightweight passive enclosure driven and protected by a dedicated powered amplified controller. The loudspeaker shall have a passive crossover which allows a direct use on standard amplifiers without additional adjustments.

The enclosure shall feature one 5" neodymium LF transducer and one 1,0" soft-dome tweeter with 1,75" diaphragm coaxial arranged. The driver configuration shall generate a coverage of 110° radially.

The usable system bandwidth shall be 90Hz to 20000kHz.

Maximum peak SPL shall be 117dB. The long-term handling capacity shall be 250W program and 500W peak. The nominal impedance of the loudspeaker shall be 24Ω.

The enclosure cabinet construction shall consist of integral rigid foam. The front of the enclosure shall be protected by a perforated, powder-coated steel with flame retardant, black fabric to the rear. The dimensions shall be 160mm (6.30in) in width, 240mm (9.45in) in height and 160mm (6.30in) in depth and the enclosure weight shall be 3.9kg (8.6lbs).

The enclosure shall feature two M10 threads for mounting accessories. The enclosure shall be connected via two parallel 4-pole speakON® sockets and clamp connection: red (+)/ black (-).

The enclosure shall achieve a protection class of IP54 with mounted WPC5.

The loudspeaker shall be the TWAUDIO C5.

References

The response curves of the system are available upon request – support@twaudio.com

Manufacturer:
TWAMBO GmbH
Karl-Hofer-Str. 42
14163 Berlin, Germany

TWAUDIO®

TWAMBO GmbH
Karl-Hofer-Str. 42
14163 Berlin
Germany

Phone: +49 7141 488989-0
Fax: +49 7141 488989-99
Mail: info@twaudio.com

