



Our versatile C5 compact loudspeaker was the inspiration for the C5i. In the identical weatherproof PU enclosure, the C5i uses a newly developed, inexpensive 5" chassis with a central dome-tweeter. As with the C5, this coaxial structure results in a radial and ideally homogeneous radiation behavior.

As usual with TWAUDIO products, the focus of the acoustic development with the C5i was also on low distortion and sound quality, but compared to the C5 the performance and the maximum level are reduced by 6 dB SPLmax.

Due to the frequency response-optimized passive crossover, the low-impedance C5i with 6 ohms is also suitable for operation on small standard amplifiers without DSP. Corresponding presets for Powersoft and Lab. Gruppen amplifier platforms are also available.

The C5i is predestined for all budget-orientated but high-quality sound reinforcements, which do not require maximum SPL but excellent sound with even radiation.

For example, for near-field applications, demanding background sound systems in bars, restaurants, shopping centers, for smaller conference rooms or for short-throw sound systems in theaters, churches or houses of worship.

All C5 accessories are also compatible with the C5i

Key Features

- » Compact, lightweight (2.4 kg | 5.3 lbs) passive loudspeaker
- » 110 degree wide radiating 5" coaxial driver
- » Passive crossover allows direct use on standard amplifiers without DSP
- » Several installation accessories available
- » IP54 rating achieved with WPC5 installation cover (with cable gland) mounted
- » Coherent phase response with all TWAUDIO subwoofers
- » Operation with dedicated TWAUDIO presets on Lab.gruppen, Powersoft or Dynacord TGX and IPX amplifiers

Applications

- » Galas, events and shows
- » Churches, houses of worship, religious places
- » Theatres and cultural places
- » Bars and restaurants
- » Arenas and sports venues
- » Concerts

Technical Data

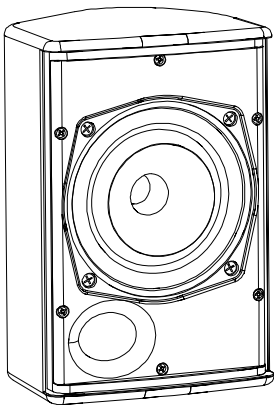

Drivers	1x 5" LF / 1x 0,7" HF
Frequency range	100 - 22000 Hz
Power capacity program/peak	100/200 W
Impedance	6 Ω
Coverage (h × v)	110° radial
Sensitivity 1 W / 1 m	88 dB
SPLmax / 1 m	111 dB
Connection	2x speakON® NL4 1± / Clamped connection: red (+) / black (-)
Dimensions (H × W × D)	240 × 160 × 160 mm 9.45 × 6.30 × 6.30 in
Weight	2.4 kg 5.3 lbs
Finish	Warnex textured paint (RAL colors optional)
Accessories	see twaudio.com

Technical Drawing

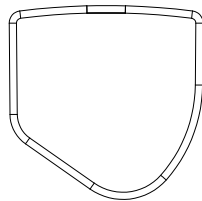

bottom view

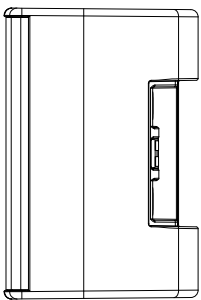

right view

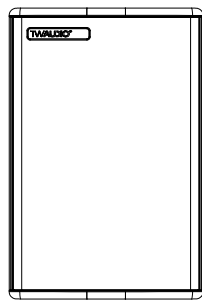

front view

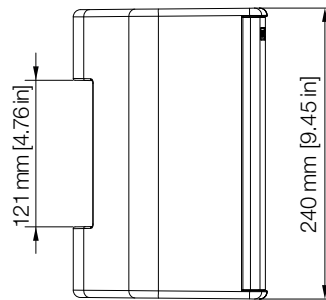

left view

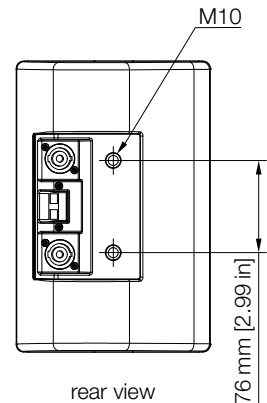

rear view

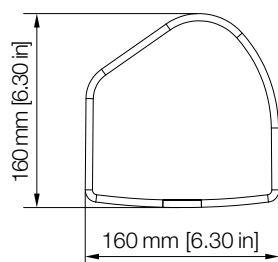

top view

Frequency Response

FULL mode / **FLAT mode** / CUT mode | IMPEDANCE

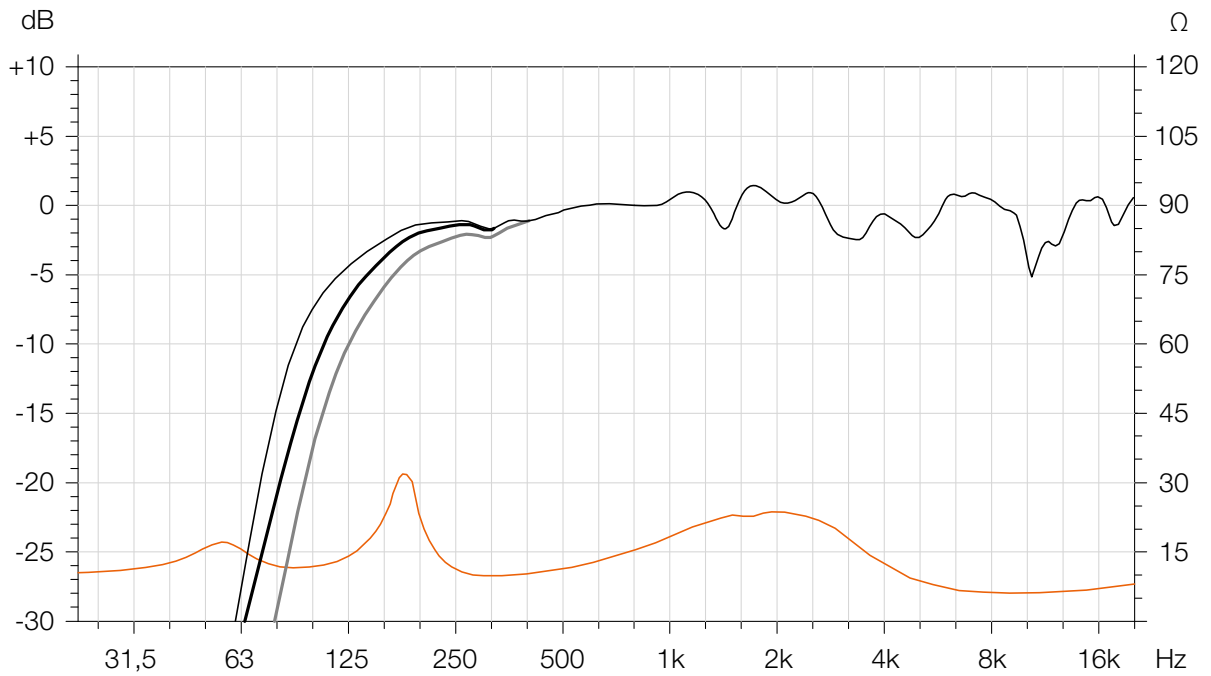

Radiation Pattern

-6 dB | -12 dB

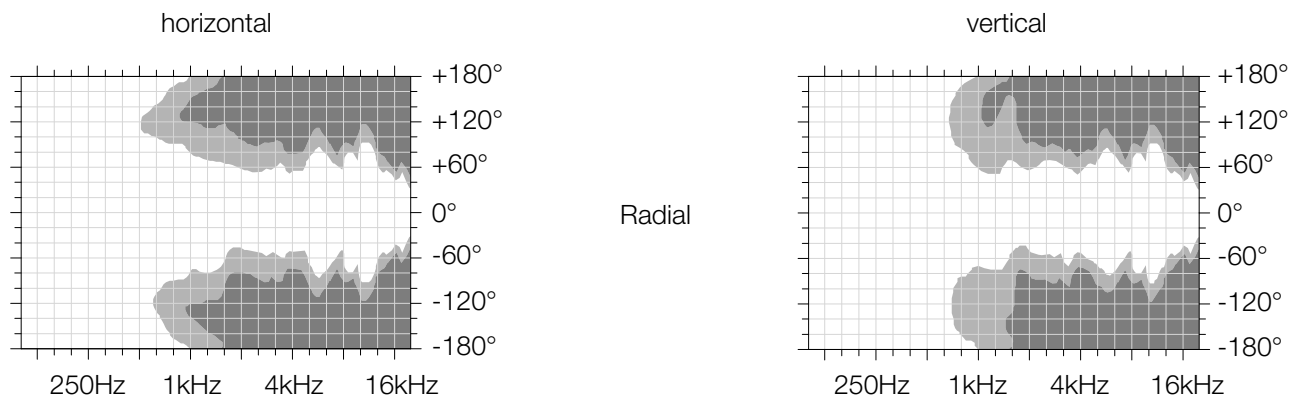

Architect Specifications

The loudspeaker shall consist of a compact and lightweight passive enclosure driven and protected by a dedicated powered amplified controller. The loudspeaker shall feature a 110 degree wide radiating 5" coaxial driver. The loudspeaker shall have a passive crossover which allows a direct use on standard amplifiers without additional adjustments. The loudspeaker shall available several installation accessories. The enclosure shall achieve an IP54 rating with mounted WPC5 installation cover (with cable gland).

The enclosure shall feature one 5" neodymium LF transducer and one 0,7" soft-dome tweeter coaxial arranged. The driver configuration shall generate a coverage of 110° radially.

The usable system bandwidth shall be 100Hz to 22000kHz.

Maximum peak SPL shall be 111dB. The long-term handling capacity shall be 100W program and 200W peak. The nominal impedance of the loudspeaker shall be 6Ω.

The enclosure cabinet construction shall consist of integral rigid foam. The front of the enclosure shall be protected by a perforated, powder-coated steel with flame retardant, black fabric to the rear. The dimensions shall be 160mm (6.30in) in width, 240mm (9.45in) in height and 160mm (6.30in) in depth and the enclosure weight shall be 2.4kg (5.3lbs).

The enclosure shall feature two M10 threads for mounting accessories. The enclosure shall be connected via two parallel 4-pole speakON® sockets and clamp connection: red (+)/ black (-).

The enclosure shall achieve a protection class of IP54 with mounted WPC5.

The enclosure shall feature a white type label with black letters.

The loudspeaker shall be the TWAUDIO C5i.

References

The response curves of the system are available upon request – support@twaudio.com

Manufacturer:
TWAMBO GmbH
Karl-Hofer-Str. 42
14163 Berlin, Germany



TWAUDIO®

TWAMBO GmbH
Karl-Hofer-Str. 42
14163 Berlin
Germany

Phone: +49 7141 488989-0
Fax: +49 7141 488989-99
Mail: info@twaudio.com