



The VERA S17i is a compact, flyable install subwoofer in a symmetrically vented enclosure, equipped with one 18" long excursion driver.

The specifically developed integrated rigging hardware allows a tightly screwed installation for perfect integration into VERA20i arrays with nearly invisible rigging parts, without the use of expensive locking pins and additional frames.

The fully symmetrical design of the rigging also allows to set up cardioid sub arrays with mechanically reversed enclosures. There is also the possibility to mount an optional front grill to the rear side of the enclosure giving a seamless look of the entire array.

The two recessed panels with screw terminals - one on the top and one on the bottom of the enclosure - allows for the signal connection between cabinets to be hidden. There are also installer options of plates with speakON®, cable gland and blanking plates available.

## Key Features

- » Flyable installation subwoofer in compact vented enclosure
- » 18" long excursion woofer with 4" coil with 2400W program power
- » Fully integrated tightly screwed installation rigging
- » Invisible cabling through connections in the enclosure's top and bottom
- » Different cable connection possibilities from above or below the enclosure
- » Coherent phase response with all TWAUDIØ loudspeakers
- » Operation with dedicated TWAUDIØ presets on Lab.gruppen, Powersoft or Dynacord TGX and IPX amplifiers

## Applications

- » Galas, events and shows
- » Churches, houses of worship, religious places
- » Theatres and cultural places
- » Bars and restaurants
- » Arenas and sports venues
- » Concerts

# VERA S17i

## DATASHEET

### Technical Data

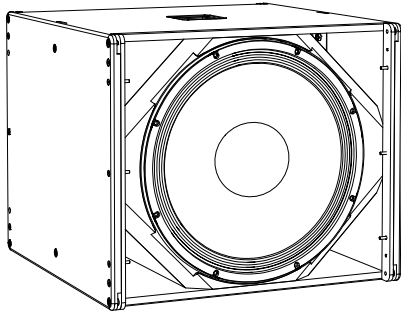

Drivers	1x 18" LF
Frequency range	37 - 110Hz
Power capacity program/peak	2400 / 4800W
Impedance	8Ω
Sensitivity 1W/1 m	96 dB
SPLmax / 1 m	132 dB
Connection	screw terminal 2± IN   1± THRU
Dimensions (H x W x D)	500 x 600 x 600 mm   19.69 x 23.62 x 23.62 in
Weight	34,0 kg   74.96 lbs
Finish	Warnex textured paint (RAL colors optional)
Accessories	see twaudio.com

### Technical Drawing

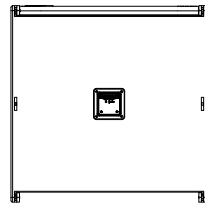

bottom view

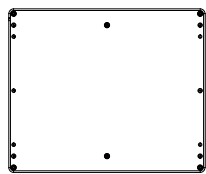

right view

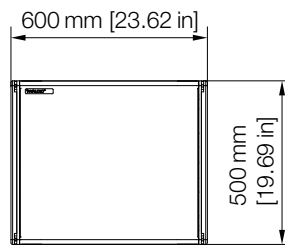

front view

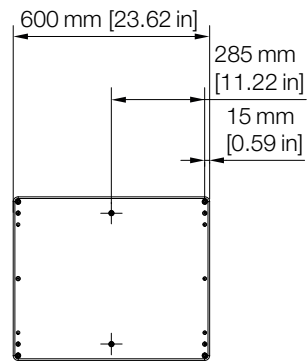

left view

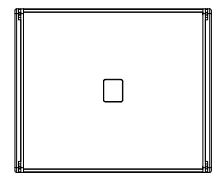

rear view

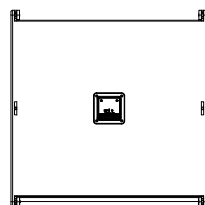

top view

## Frequency Response

FULL mode | IMPEDANCE

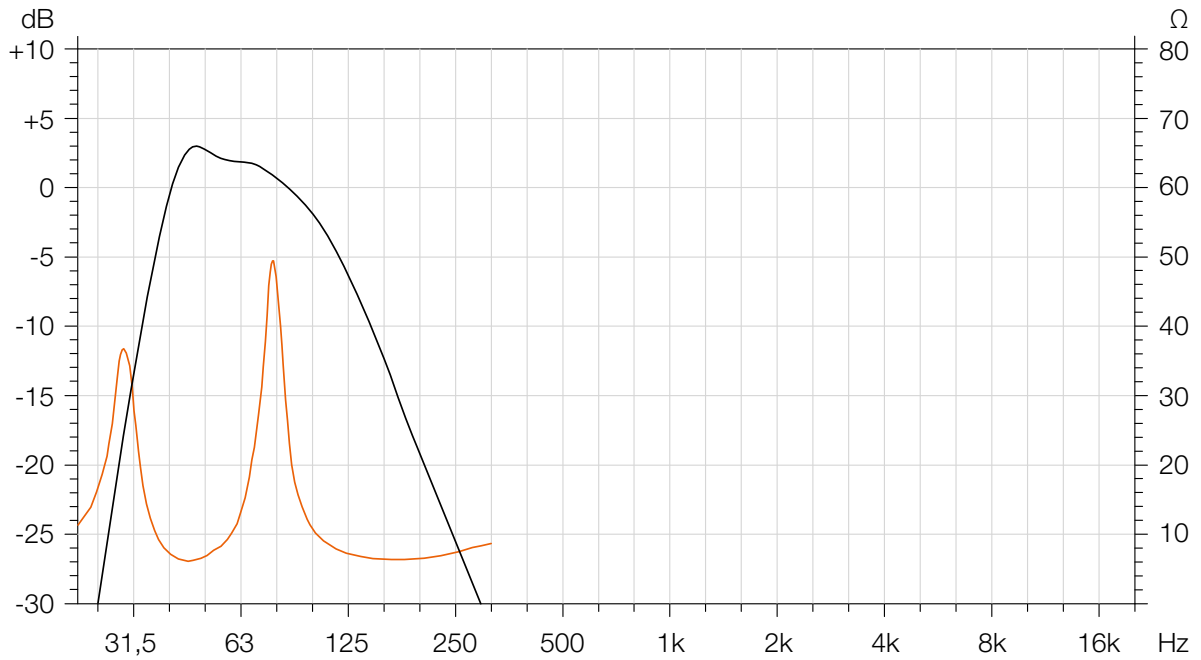

## Polar Pattern

40Hz | 63Hz | 100Hz

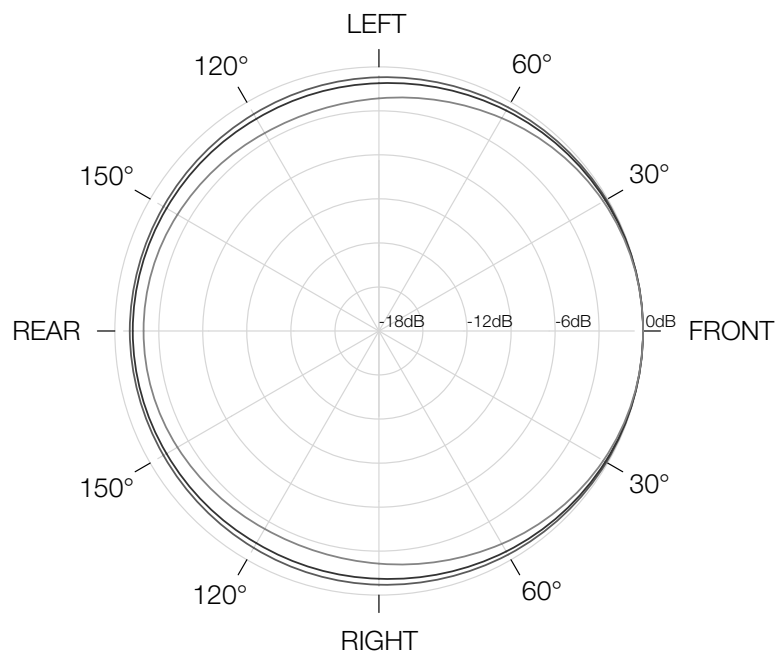

## Architect Specifications

The loudspeaker shall consist of a compact vented flyable installation enclosure driven and protected by a dedicated powered amplified controller. The loudspeaker shall be a single-channel omnidirectional subwoofer. The loudspeaker shall feature a fully integrated tightly screwed installation rigging. The loudspeaker shall have a invisible cabling through connections in the enclosure's top and bottom. The loudspeaker shall have different cable connection possibilities from above or below the enclosure.

The enclosure shall feature one 18" long excursion neodymium LF transducer with 4" coil.

The usable system bandwidth shall be 37 Hz to 110 Hz.

Maximum peak SPL shall be 132 dB. The long-term handling capacity shall be 2400 W program and 4800 W peak. The nominal impedance of the loudspeaker shall be 8 Ω.

The enclosure cabinet construction shall consist of first grade birch plywood. The front of the enclosure shall be protected by a perforated, powder-coated steel with flame retardant and hydrophobic, black fabric to the rear. The dimensions shall be 600 mm (23.62 in) in width, 500 mm (19.69 in) in height and 600 mm (23.62 in) in depth and the enclosure weight shall be 39.7 kg (88 lbs).

The enclosure shall feature a four-point-rigging for mounting accessories. The four-point-rigging shall feature two splay links at the front and two brackets in the middle of the side for connection with lock washers and screws. The enclosure shall be connected via screw terminals on top and on bottom as standard.

The loudspeaker shall be the TWAUDIO VERAS17i.

### References

The response curves of the system are available upon request – support@twaudio.com

Manufacturer:  
 TWAMBO GmbH  
 Karl-Hofer-Str. 42  
 14163 Berlin, Germany



**TWAUDIO®**

TWAMBO GmbH  
 Karl-Hofer-Str. 42  
 14163 Berlin  
 Germany

Phone: +49 7141 488989-0  
 Fax: +49 7141 488989-99  
 Mail: info@twaudio.com